

Exhibitor Information

Northwest Indian Gaming Conference & Expo

June 18 - 20, 2018 · Little Creek Casino Resort



Sponsored by:



Welcome back to the 2018 show at the Little Creek Casino Resort!

Dates: June 18 - 20, 2018

June 18, 2018 – Golf Outing at Salish Cliffs Golf Club, Shotgun Start at 10:00 AM. Reception 6:00 PM at Little Creek Casino.

June 19, 2018 – General Session at 9:00 AM. Breakouts 10:45 AM. Luncheon 12:00 PM. Tradeshow 4:00 to 7:00 PM.

June 20, 2018 – Continental Breakfast 9:00 AM. Breakout Sessions 9:30 AM. Tradeshow 9:00 AM to 2:00 PM.

Increase Your Visibility, Sponsor an Event

If you would like to increase your company's visibility, please consider sponsoring one of the many activities for our attendees: the Annual Northwest Golf Outing, Receptions, Luncheons, Coffee Breaks or even Prize Drawings, to name a few! Contact the official show manager, Heidi Buss, 651-335-4915 for a complete list of sponsorship levels.

Other Exhibitor Information

Northwest Golf Outing

The Annual Northwest Indian Gaming Golf Outing will be held Monday, July 18, 2018 with a shotgun start at 10:00 AM. This year the tournament will be held at the beautiful Salish Cliffs Golf Club, owned by the Squaxin Island Tribe. The best news of all is the golf course is on site. This event always sells out and there is only space for 144 golfers (no walk-ups) so register early! Please use the separate golf registration form for your employees and clients. Remember, all proceeds benefit the WIGA scholarship fund.

Official Show Manager

Our show manager this year is Heidi Buss at 651-335-4915 or FAX 651-917-3578 or email at hbuss@msn.com.

Official Services Contractor for Transportation, Electrical, Decorating, Furniture and Carpeting

GES is our official show services contractor which includes transportation, material handling, electrical and plumbing, cleaning, overhead sign hanging, labor and rental of equipment, furniture, carpeting, and signage.

Once you have returned your exhibitor contract and payment to WIGA, GES will send you a service manual by email for all extra services. Please remember to put your correct email address on the contract. **The hall is carpeted**, but if you want additional carpeting, please order through GES.

The GES phone number is 425-251-6565. Greg Casey is the show coordinator for GES.

Floor Plan and Booth Assignments

Once you have returned your exhibitor contract and payment to WIGA with your preferred booth space request, your contact information will be sent to Heidi Buss and to GES. Heidi will assign your booth location based on the preferences in your exhibitor contract. The floor plan for the Expo Ballroom Hall is attached.

Where to Send Contracts and for Billing Questions

Glenda Breiler

Phone: 360-352-3248

Washington Indian Gaming Association
1110 Capitol Way S. Suite 404
Olympia, WA 98501-2251

You may send the contract by FAX to 360-352-4819 or by email to glendabreiler@rainierconnect.com.

Please make checks payable to Washington Indian Gaming Association.

2018 NW Exhibitor Schedule & Information

Location

Little Creek Casino Resort
91 West State Route 108
Shelton, WA 98584
Phone: 800-667-7711

Tradeshow Expo Hours

Tuesday, July 19, 2018 4:00 – 7:00 PM
Wednesday, July 20, 2018 9:00 AM – 2:00 PM

Floor Plan

SEE INSERT

Set Up/Tear Down Schedule

Large Exhibits Only: (Over 4 booths or heavy electrical)
Monday, June 18, 2018 from 1:00 PM – 6:00 PM

All Other Exhibitors:

Set Up: Tuesday, June 19, 2018, 8:00 AM – 3:30 PM
Tear down: Wednesday, June 20, 2018, 2:00 – 6:00 PM

Booth Prices

Single Booth: \$1,650.00
Additional Booths: \$1,550.00 each

WIGA member discount: \$100 / booth

All Booths are 10 ft. deep x 10 ft. wide

You may send the contract by FAX to 360-352-4819 or by email to glendabreiler@rainierconnect.com.

Hotel Information

Each exhibitor is allowed to make reservations for two rooms per booth space. Please submit your booth contract before making reservations. You should make your reservations directly with Little Creek Casino Resort. WIGA will monitor hotel room space periodically to make sure there are rooms for tribal attendees (your customers).

Little Creek Room Rate: \$99.00, Suites start at \$169.00

Hotel RL (previously Red Lion Inn) Rate: \$113.00, Phone: 360-943-4000

Hilton Garden Inn Olympia Rate: \$139.00, Phone 360-236-9934

Exhibit Installation and Removal

Only large exhibitors will have access to the Exhibit Hall on Monday June 18, 2018 from 1:00 to 6:00 PM. All other Exhibitors may move in to the exhibit hall on Tuesday, June 19, 2018, starting at 8:00 AM. **If special circumstances arise and you need more set-up time, please call Heidi at 651-335-4915.** All exhibits must be set up by 4:00 PM on Tuesday, June 19, 2018 for the show opening and must be removed by 6:00 PM on Wednesday, June 20, 2018.

Shipping and Receiving

Freight handling and warehouse services must be arranged through GES, the show decorator. Once we receive your contract, GES will contact you April 1, 2018 with shipping instructions. Any packages that are sent to Little Creek for pre-event storage must be sent in the following manner: (1) The package must be sent to the attention of "Resort Sales Manager", (2) on the address label please indicate, "Hold for NW Indian Gaming Conference group event beginning June 18, 2018." Packages sent more than three (3) days prior to the event will be subject to a \$15.00 per package per day charge. Little Creek is not responsible for packages that are lost, stolen, or damaged.

Exhibit Cleanup

Upon tear down, exhibitors must place all trash in receptacles designated by the Little Creek Resort and GES.

Security

Security will be provided during the run of the show. Although security will be present at all times, you are advised to remove valuable items from your booth when you are not present.

For all other exhibitor questions

Please contact our Tradeshow Manager, Heidi Buss at:

670 Summit Ave.
Saint Paul, MN 55105

Phone: 651-917-2301
Cell: 651-355-4915
Fax: 651-917-3578
Email: hbuss@msn.com

Little Creek Expo Hall Floor Plan

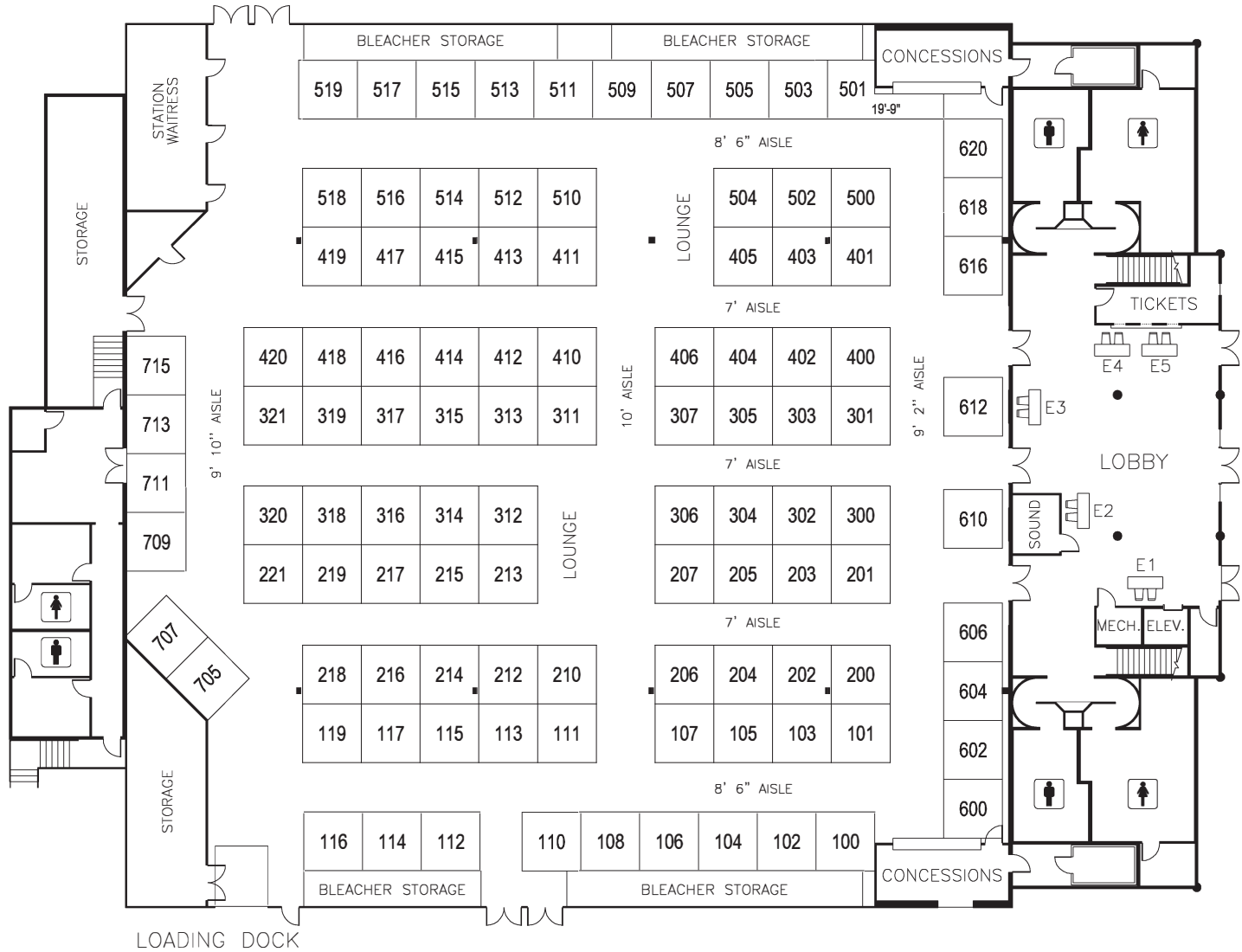

MOVE IN
June 19, 2018, 8:00 AM – 3:30 PM
Large exhibits only:
June 18, 2018 / 1:00 – 6:00 PM

TRADE SHOW
June 19, 2018, 4:00 – 7:00 PM
June 20, 2018, 9:00 AM – 2:00 PM

MOVE OUT
June 20, 2018

QUESTIONS?
Call Heidi Buss at
651-335-4915
Email: hbuss@msn.com

CONFIRM YOUR SPACE:
EMAIL form to Glenda at glendabreiler@rainierconnect.com
FAX form to 360-352-4819 or CALL 360-352-3248
MAIL form to WIGA, 1110 Capitol Way S., Suite 404, Olympia, WA 98501-2251